

Toothed channel type JXA W 38/23

JXA W 38/23

**Load range 12.0 kN**  
*16.8 kN*

$f_v$  **3.0 kN**  
A4 **2.4 kN**

Weight with anchors: 2.70 kg/m<sup>3</sup>

Design resistance to Eurocode

$F_{Rd} = perm. F \times 1.4$

The design values of the load bearing capacities are shown in *italics* in the tables.

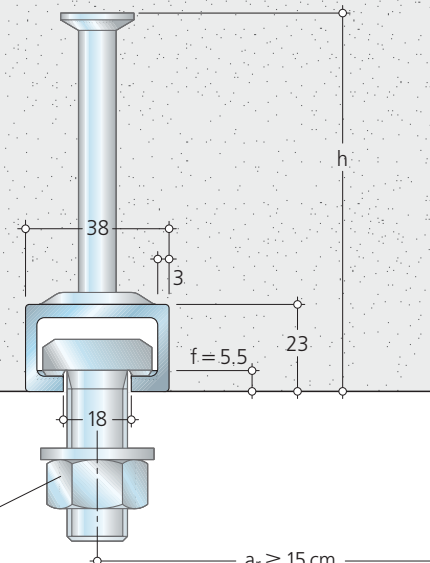

JORDAHL® anchor channels JXA can be used for loads in all directions.

Depending on the bolt used, the following stress regions are distinguished:

**Stress at right angles to the channel longitudinal axis**

**Hammerhead bolts type JH, JUH**

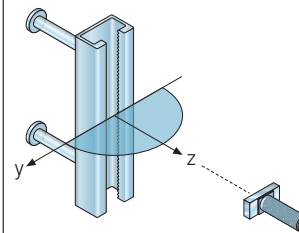

JORDAHL® bolts type JH/JUH are not approved for loads in the channel longitudinal direction. Bolt range → p. 11

$$\sqrt{F_z^2 + F_y^2} \leq perm. F$$

**Stressing in all directions**

**Toothed bolts type JXH**

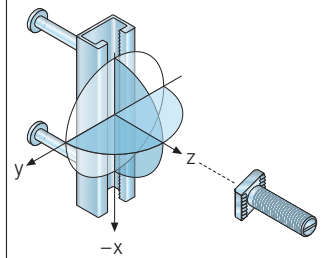

In the event of simultaneous stressing in longitudinal tension (x), transverse tension (y) and central tension (z), the resultant load must not exceed permissible loads on the bolts according to the table alongside.

$$\sqrt{F_x^2 + F_z^2 + F_y^2} \leq perm. F$$

Type	JXA W 38/23			
<b>Material Design</b>	S275JR <i>f<sub>v</sub></i>	1.4401/1.4404/1.4571 (A4) Round anchor A4		
<b>permissible point load [kN]<sup>1)</sup> ≥ C 20/25</b>	Approved for dynamic loads 12.0 <i>16.8</i>			
<b>Anchor design<sup>2)</sup></b>	R	I 125	R	I 125
<b>Installation height h [mm]</b>	100	150	100	150
<b>Filler</b>	Polystyrene filling (PS)			

- 1) Max. permissible load as per Building Approval. Permissible loads for the respective application → p. 33, C 20/25 Δ B 25.
- 2) Anchor design: R = round anchor (standard design), I = weld-on anchor in exceptional cases, supply not binding.
- 3) Weight per metre for mill finish steel (for galvanized profiles: weight per metre × 1,10) (for stainless steel: weight per metre × 1,02)

**Lengths supplied: JXA W 38/23**

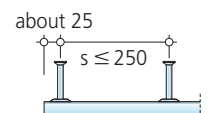

	Length [mm]	Anchor (no.)	Anchor spacing s
<b>Short pieces</b>	150	2	100
	200	2	150
	250	2	200
	300	2	250
	350 – 550	3	≤ 250
	600 – 800	4	≤ 250
	850 – 1050	5	≤ 250
<b>Cut lengths</b>	1050 < L < 6000 on request		≤ 250
<b>Stock lengths</b>	6000 (-0/+50)	25	≤ 250

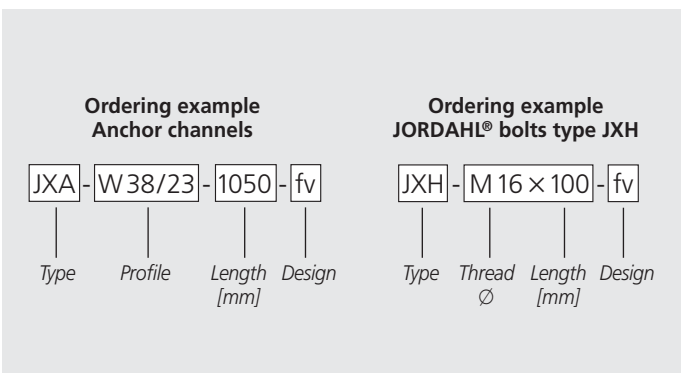

JORDAHL® anchor channels JXA W38/23 for fixing curtain wall joints.

**JORDAHL® bolts type JH/JUH; JXH**

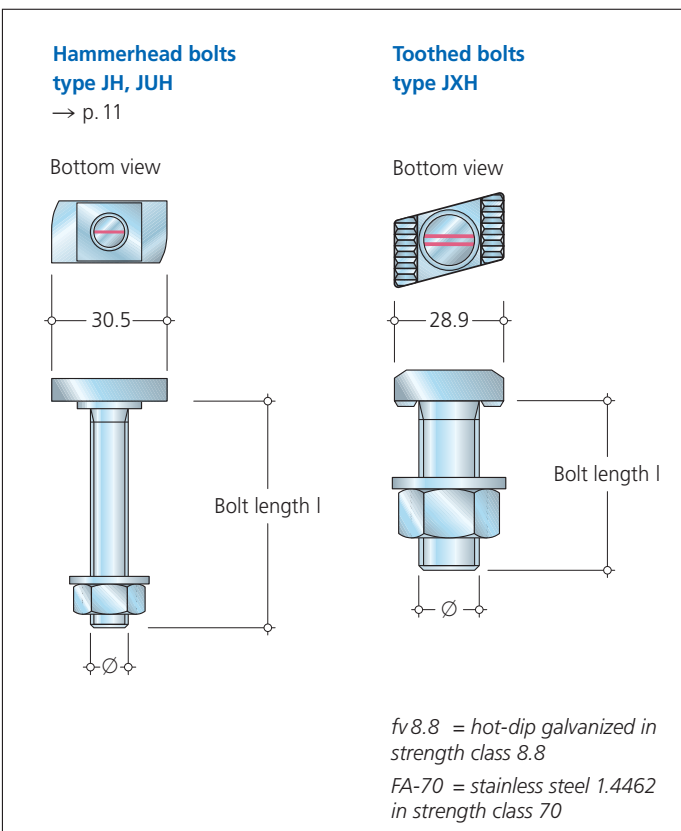

Bolt range JXH		
Length l [mm]	JXH M12	JXH M16
30	fv 8.8	fv 8.8
40	fv 8.8 FA-70	fv 8.8 FA-70
50	fv 8.8	fv 8.8
60	fv 8.8 FA-70	fv 8.8 FA-70
80	fv 8.8 FA-70	fv 8.8
100	fv 8.8	fv 8.8
125		fv 8.8
150		fv 8.8

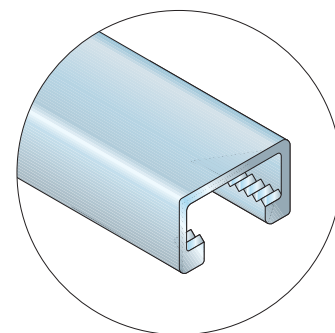

Type JH, JUH → p. 11

Permissible bolt loads under tension, oblique tension or shear load					
Type Ø	Recommended tightening torque $M_A$ [Nm] <sup>4)</sup>	Permissible load perm. $F^{1)}/F_{Rd}$ [kN]		Permissible bending moment perm. $M^{2)3)}/M_{Rd}$ [Nm]	
		8.8	FA-70	8.8	FA-70
JXH M12	80	19.4 27.2	12.6 17.6	43.7 61.2	32.8 45.9
JXH M16	120	36.1 50.5	23.6 33.0	111.0 155.4	83.3 116.6

Notes → p. 40

**Associated edge spacings [cm]**

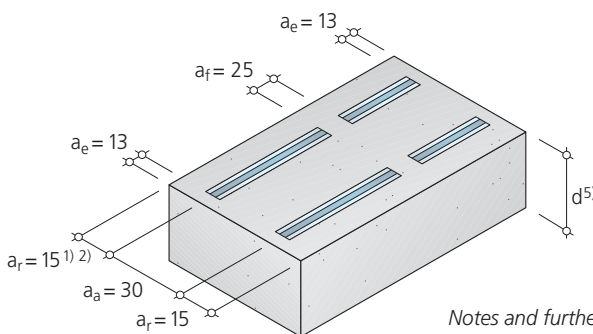

Notes and further minimum spacings → p. 35