

Toothed channel type JXA W 29/20

JXA W 29/20

**Load range 8.0 kN**  
*11.2 kN*

**f<sub>v</sub> 2.0 kN**  
**A4 1.8 kN**

Weight with anchors: 1.70 kg/m<sup>3</sup>

Design resistance to Eurocode

***F<sub>Rd</sub> = perm. F × 1.4***

The design values of the load bearing capacities are shown in *italics* in the tables.

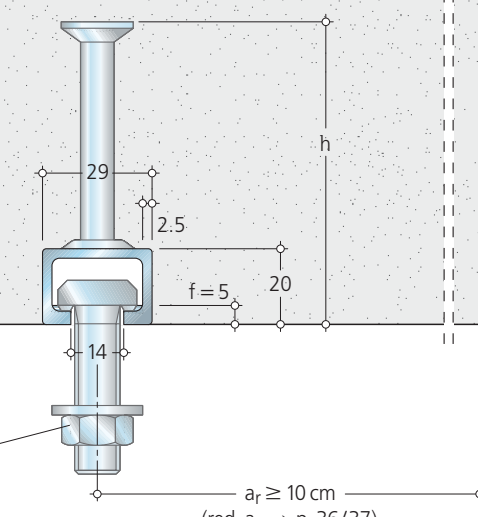

JORDAHL® anchor channels JXA can be used to absorb loads in all directions.

Depending on the bolt used, the following stress regions are distinguished:

**Stress at right angles to the channel longitudinal axis**

**Hammerhead bolts type JD, JUD**

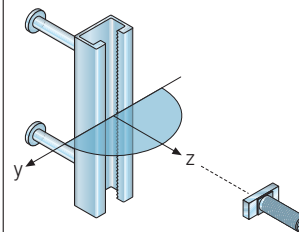

JORDAHL® bolts type JD/JUD are not approved for loads in the channel longitudinal direction. Bolt range → p. 9

$$\sqrt{F_z^2 + F_y^2} \leq \text{perm. } F$$

**Stressing in all directions**

**Toothed bolts type JXD**

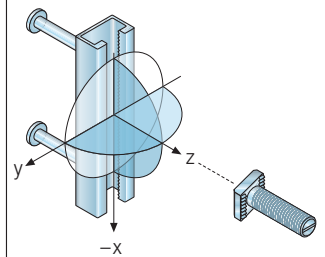

In the event of simultaneous stressing in longitudinal tension (x), transverse tension (y) and central tension (z), the resultant load must not exceed permissible loads on the bolts according to the table alongside.

$$\sqrt{F_x^2 + F_z^2 + F_y^2} \leq \text{perm. } F$$

Type	JXA W 29/20			
<b>Material Design</b>	S275JR f <sub>v</sub>		1.4401/1.4404/1.4571 (A4) round anchor A4	
<b>permissible point load [kN]<sup>1)</sup> ≥ C 20/25</b>	Approved for dynamic loads 8.0 <i>11.2</i>			
<b>Anchor design<sup>2)</sup></b>	R	I 60	R	I 60
<b>Installation height h [mm]</b>	80	80	80	80
<b>Filler</b>	Polystyrene filling (PS)			

- 1) Max. permissible load as per Building Approval. Permissible loads for the respective application → p. 33, C 20/25 Δ B 25.
- 2) Anchor design: R = round anchor (standard design), I = weld-on anchor in exceptional cases, supply not binding.
- 3) Weight per metre for mill finish steel (for galvanized profiles: weight per metre × 1,10) (for stainless steel: weight per metre × 1,02)

**Lengths supplied: JXA W 29/20**

	Length [mm]	Anchor (no.)	Anchor spacing s
<b>Short pieces</b>	150	2	100
	200	2	150
	250	2	200
	300 – 450	3	≤ 200
	500 – 650	4	≤ 200
	700 – 850	5	≤ 200
	900 – 1050	6	≤ 200
<b>Cut lengths</b>	1050 < L < 6000 on request		≤ 200
<b>Stock lengths</b>	6000 (-0/+50)	31	≤ 200

**Ordering example  
Anchor channels**

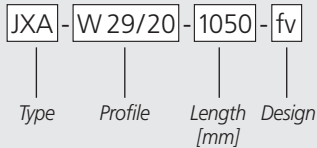

**Ordering example  
JORDAHL® bolts type JXD**

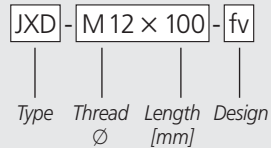

Space-saving storage of pallets in a high-bay store. Use of the toothed channel JXA W 29/20 specifically to absorb the vertical loads from the adjacent construction.

**JORDAHL® bolts type JD/JUD; JXD**

**Hammerhead bolts  
type JD, JUD**

→ p. 9

Bottom view

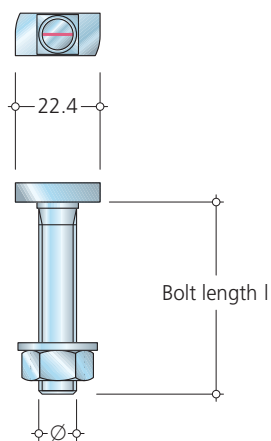

**Toothed bolts  
type JXD**

Bottom view

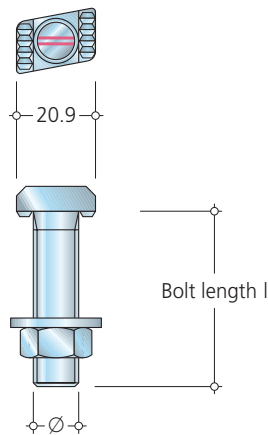

fv 8.8 = hot-dip galvanized in strength class 8.8  
FA-70 = stainless steel 1.4462 in strength class 70

**Bolt range JXD**

Length l [mm]	JXD M10	JXD M12
30		fv 8.8
40	fv 8.8	fv 8.8 FA-70
50		fv 8.8
60		fv 8.8 FA-70
80		fv 8.8 FA-70
100		fv 8.8
125		fv 8.8
150		fv 8.8

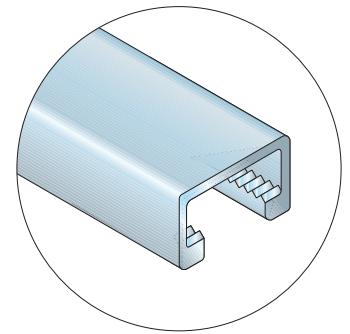

Type JD, JUD → p. 9

**Permissible bolt loads**

under tension, oblique tension or shear load

Type Ø	Recommended tightening torque M <sub>A</sub> [Nm] <sup>4)</sup>	Permissible load perm. F <sup>1)</sup> /F <sub>Rd</sub> [kN]		Permissible bending moment perm. M <sup>2)3)</sup> /M <sub>Rd</sub> [Nm]	
		8.8	FA-70	8.8	FA-70
JXD M10	40	13.3 18.6	8.7 12.2	24.9 34.9	18.7 26.2
JXD M12	80	19.4 27.2	12.6 17.6	43.7 61.2	32.8 45.9

Notes → p. 40

**Associated edge spacings [cm]**

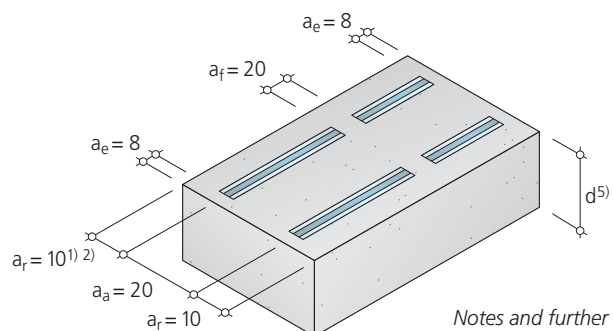

Notes and further minimum spacings → p. 35